

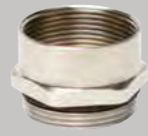





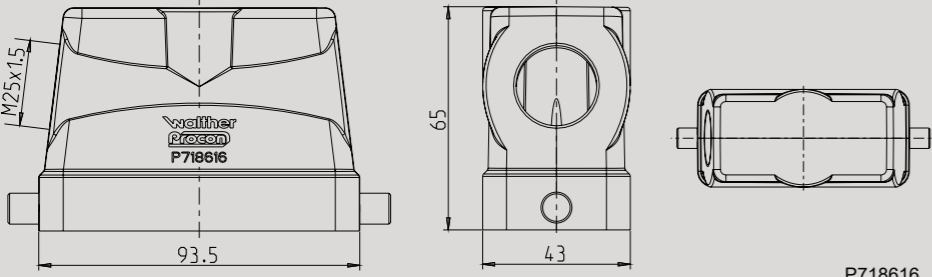

Specifications	Series	Cable gland sizes		Housings without cable glands	matching collars	matching cable glands	Housings: Double locking system
				Part no.:	Part no.:	Part no.:	
<p>Housings</p> <p>Material: Aluminum die cast Surface: Powder coated Locking levers: Plastic PA6 Housing gasket: NBR Temperature range: - 40 °C up to + 125 °C (depending on cable gland) Protection degree acc. to DIN EN 609: IP 65 (in locked condition)</p>							
 <p>P718616</p>							
<p>Hoods, aluminum, height 65 mm with single locking lever, side cable entry</p> <p>Please order the necessary quantity of collars + cable glands separately.</p>	B16 BA6 BB32 D40 DD72 MOB16	1 x M25 1 x M32	10 171 167	P718616 P718716	710939 710940	719630 710931	
 <p>P712624</p>							
<p>Hoods, aluminum, height 65 mm with single locking lever, side cable entry</p> <p>Please order the necessary quantity of collars + cable glands separately.</p>	B24 BB46 D64 DD108 MOB24	1 x M25 1 x M32	10 207 208	P712624 P712724	710939 710940	719630 710931	
 <p>P710210</p>							
<p>Hoods, aluminum, height 56 mm for double locking levers, side cable entry</p> <p>Please order the necessary quantity of collars + cable glands separately.</p>	B10 BB18 DD42 MOB10	1 x M20 1 x M25	10 130 125	P712010 P712110	710938 710939	719629 719630	
 <p>P712210</p>							
<p>Hoods, aluminum, height 56 mm for double locking levers, top cable entry</p> <p>Please order the necessary quantity of collars + cable glands separately.</p>	B10 BB18 DD42 MOB10	1 x M20 2 x M20 1 x M25	10 133 129 127	P712210 P71221000 P712310	710938 710938 710939	719629 719629 719630	
 <p>P718016</p>							
<p>Hoods, aluminum, height 65 mm for double locking levers, side cable entry</p> <p>Please order the necessary quantity of collars + cable glands separately.</p>	B16 BA6 BB32 D40 DD72 MOB16	1 x M25 1 x M32	10 167 163	P718016 P718116	710939 710940	719630 719631	

**Specifications**

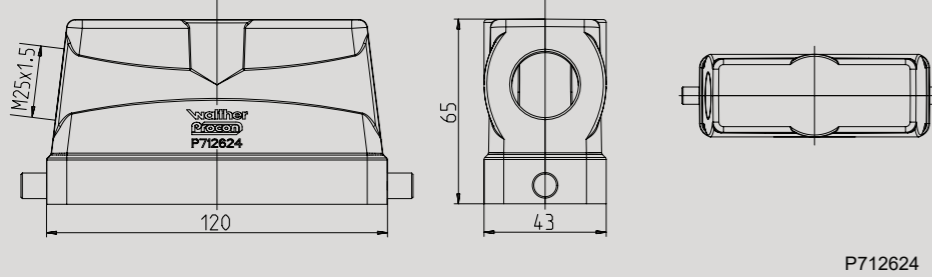
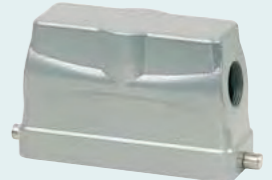
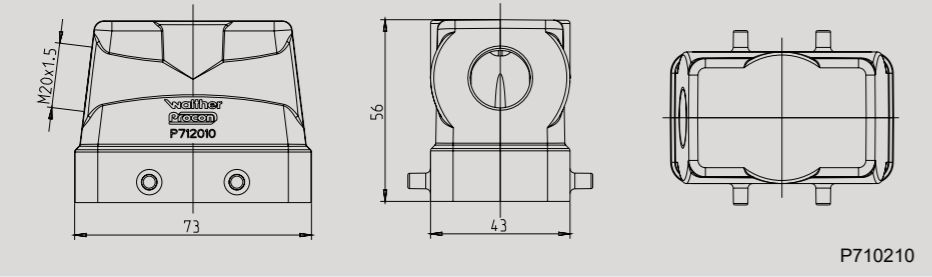
**Housings**

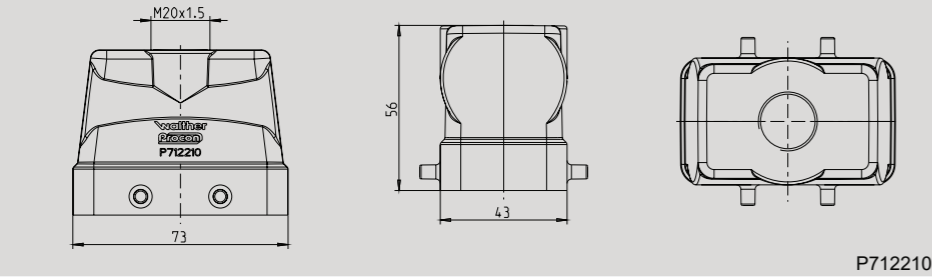
Material: Aluminum die cast  
 Surface: Powder coated  
 Locking levers: Plastic PA6  
 Housing gasket: NBR  
 Temperature range: - 40 °C up to + 125 °C (depending on cable gland)  
 Protection degree acc. to DIN EN 60 529: IP 65 (in locked condition)

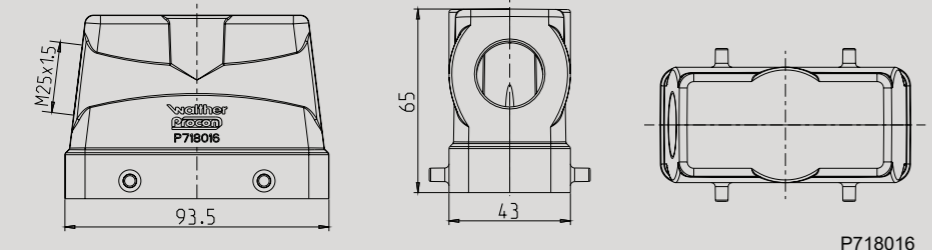
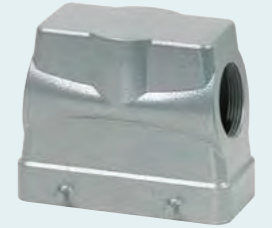
Series

Cable gland sizes



Housings without cable glands

matching collars

matching cable glands

Housings: Double locking system

Part no.:

Part no.:

Part no.:

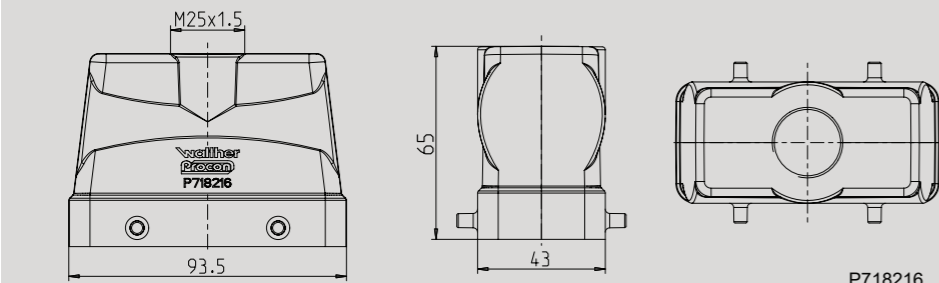

P718216

Hoods, aluminum, height 65 mm for double locking levers, top cable entry  
 Please order the necessary quantity of collars + cable glands separately.

B16		10			
BA6					
BB32	1 x M25	174	P718216	710939	719630
D40					
DD72	2 x M25	160	P71821600	710939	719630
MOB16	1 x M32	164	P718316	710940	719631

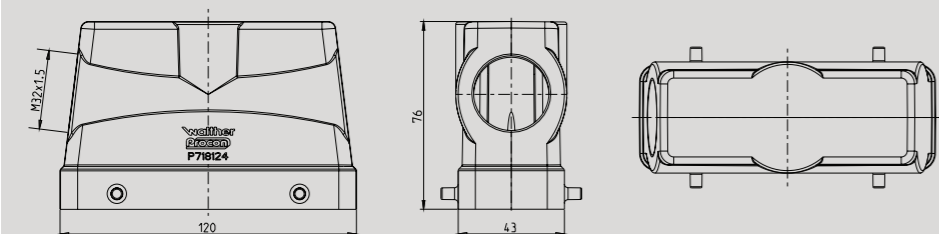
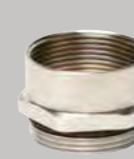

P718124

Hoods, aluminum, height 76 mm for double locking levers, side cable entry  
 Please order the necessary quantity of collars + cable glands separately.

B24		10			
BB46					
D64					
DD108	1 x M32	218	P718124	710940	719631
MOB24	1 x M 40	211	P71812440	710941	719632

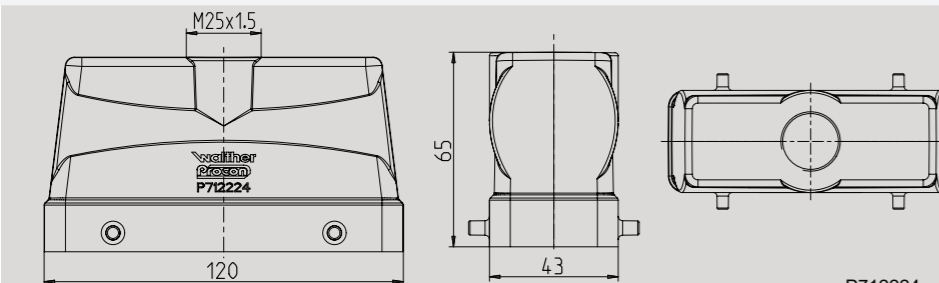

P712224

Hoods, aluminum, height 65 mm for double locking levers, top cable entry  
 Please order the necessary quantity of collars + cable glands separately.

B24		10			
BB46					
D64	1 x M25	199	P712224	710939	719630
DD108					
MOB24	2 x M25	188	P71222400	710939	719630
	1 x M32	191	P712324	710940	719631

