

Specifications

Housings

Material: Aluminum die cast
 Surface: Powder coated
 Locking levers: Plastic PA6
 Housing gasket: NBR
 Temperature range: - 40 °C up to + 125 °C (depending on cable gland)
 Protection degree acc. to DIN EN 60 529: IP 65 (in locked condition)

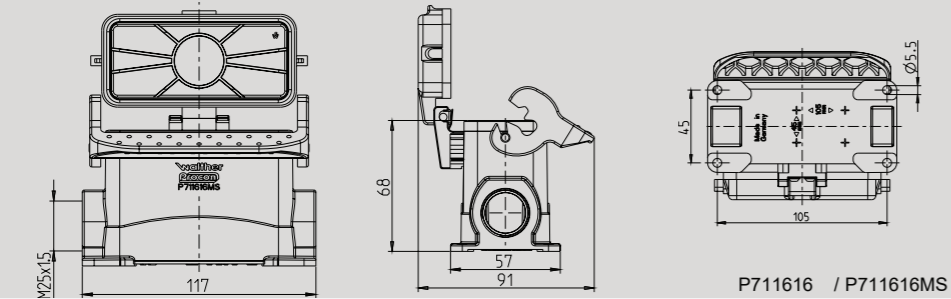

Wall mount housings, aluminum, height 68 mm with single locking lever, with plastic hinged lid

Please order the necessary quantity of glands separately.

AL = aluminum hinged lid

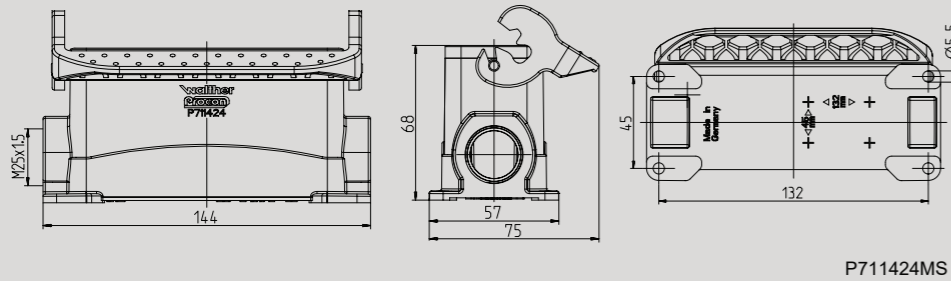

Wall mount housings, aluminum, height 68 mm with single locking lever,

Please order the necessary quantity of glands separately.

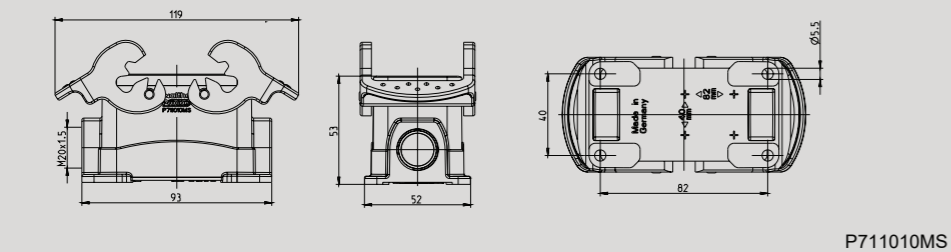

Wall mount housings, aluminum, height 53 mm with double locking levers

Please order the necessary quantity of glands separately.

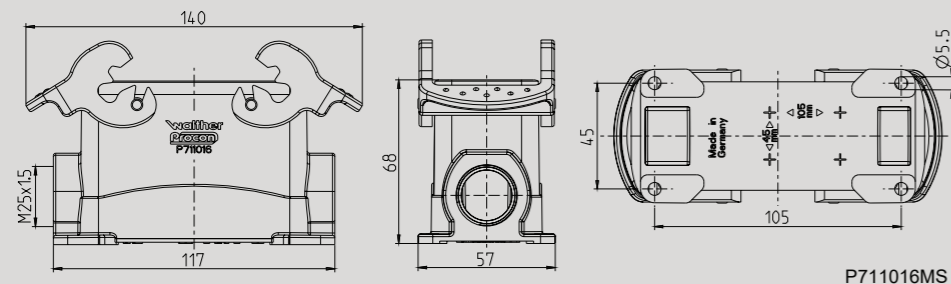

Wall mount housings, aluminum, height 68 mm with double locking levers

Please order the necessary quantity of glands separately.

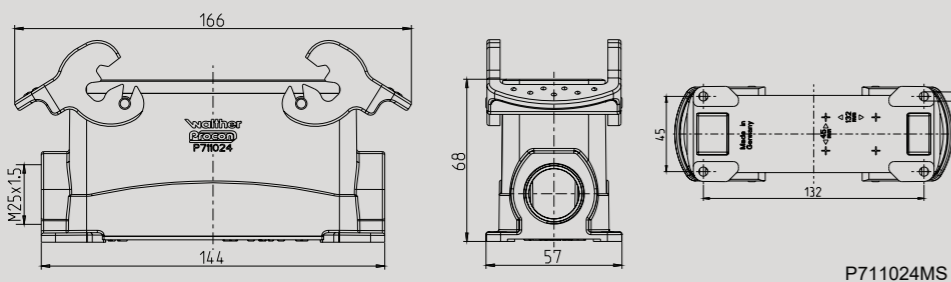

Wall mount housings, aluminum, height 68 mm with double locking levers

Please order the necessary quantity of glands separately.

Series	Cable gland sizes		Housings without cable glands	matching collars	matching cable glands	Housings: Double locking system
			Part no.:	Part no.:	Part no.:	
B16 BA6 BB32 D40 DD72 MOB16	1 x M25 1 x M25 2 x M25 2 x M25	369 422 362 415	P711616MS P711616MSAL P711716MS P711716MSAL		717638 717638 717638 717638	
B24 BB46 D64 DD108 MOB24	1 x M25 2 x M25	260 257	P711424MS P711524MS		717638 717638	
B10 BB18 DD42 MOB10	1 x M20 2 x M20	221 219	P711010MS P711110MS		717637 717637	
B16 BA6 BB32 D40 DD72 MOB16	1 x M25 2 x M25	339 333	P711016MS P711116MS		717638 717638	
B24 BB46 D64 DD108 MOB24	1 x M25 2 x M25	398 391	P711024MS P711124MS		717638 717638	